

## RETAIL/OFFICE SPACE FOR LEASE

**LOCATION: 711 PROSPECT AVENUE, WESTBURY NY 11590**

**IDENTIFIED AS: SECTION 11 BLOCK 100 LOT 123**

**PROPERTY TYPE: B-A DISTRICT**

**\$21 per sq. ft.**



**S & D Real Estate**  
27 East Jericho Turnpike– Suite 2  
Mineola, New York 11501  
516-248-6905

**CONTACT: MARTIN MILLER 813-505-2451**



- 
- **LAST SPACE AVAILABLE**
  - **JOIN: DENTAL OFFICE, BARBER SHOP, CARIBBEAN SPECIALTY MARKET, AND RESTAURANT**
  - **STRATEGICALLY LOCATED AT BRUSH HOLLOW ROAD AND PROSPECT AVENUE**
  - **LOCATED IN WESTBURY RIGHT NEXT TO THE HEART OF NEW CASSEL “REDEVELOPMENT DISTRICT”**
  - **NEWLY BUILT, GROUND FLOOR CONSTRUCTION, CONSISTING OF A TOTAL OF 1,625 SF**
  - **PLENTY OF STREET PARKING AND MUNICIPAL PARKING**
  - **UNDERGROUND PARKING FOR TENANTS**

# LOCATION MAP

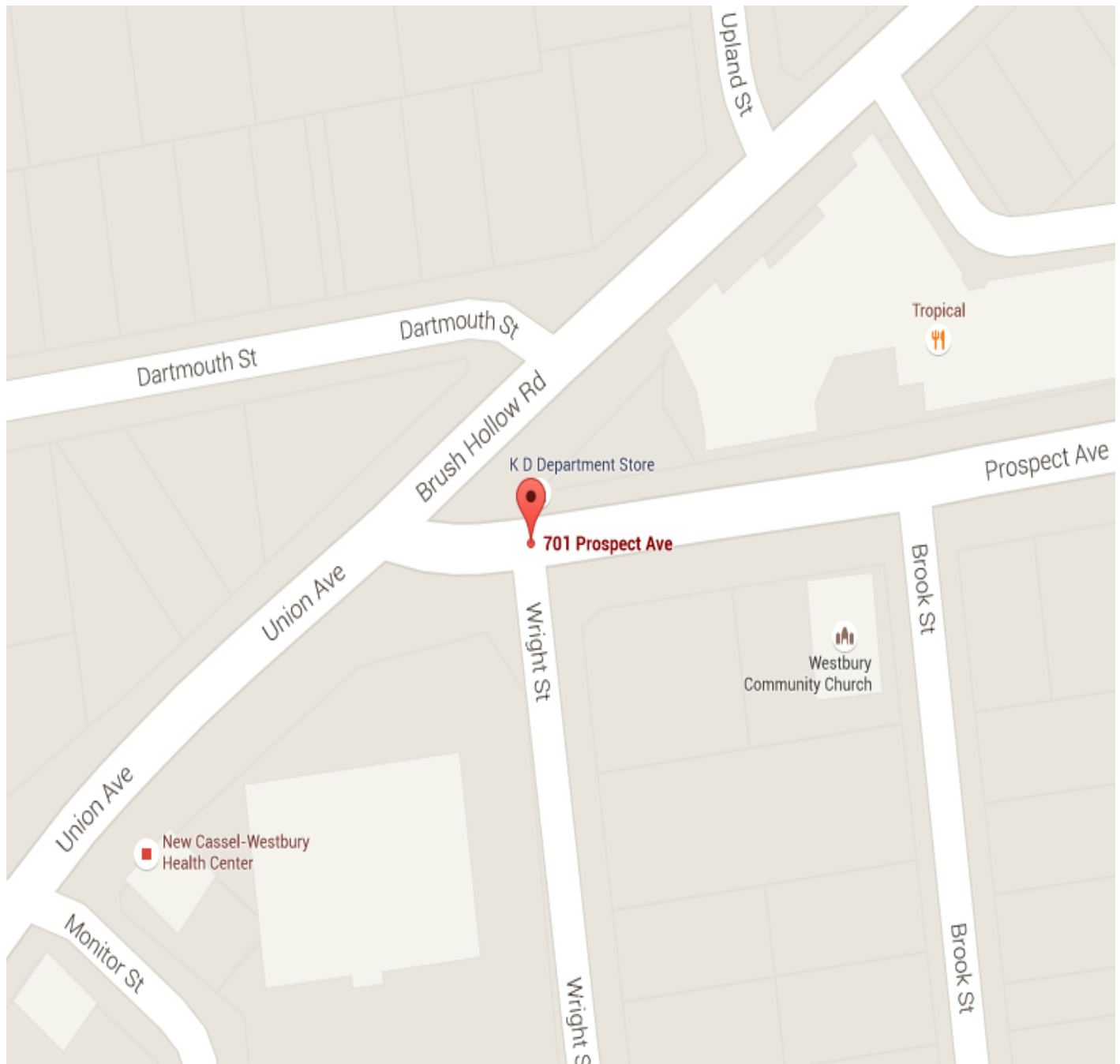

# SITE PLAN

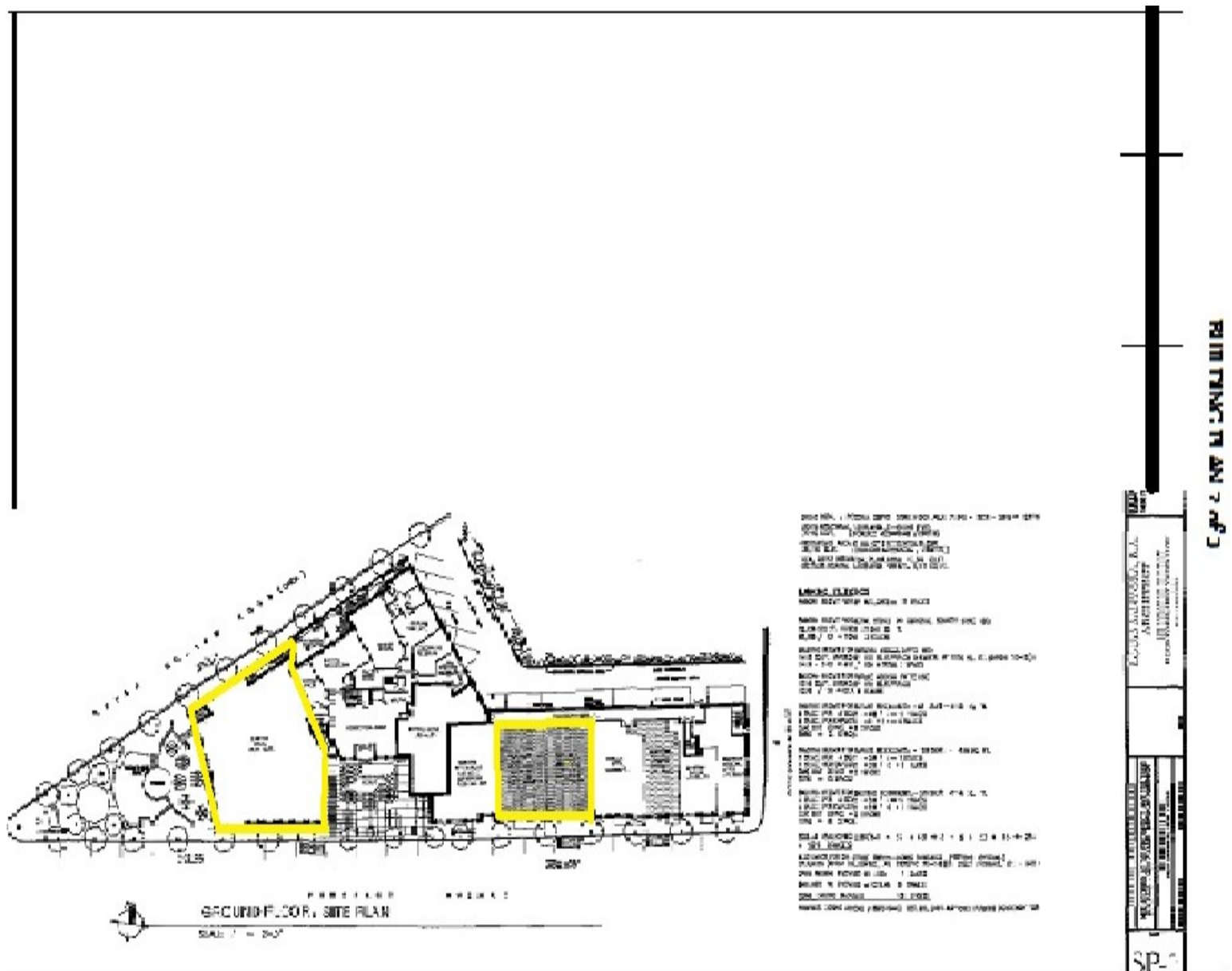

Left space: 4,400 sq. ft.  
Right Space: 3,330 sq. ft.  
*Divisible into two 1,650 sq. ft. units*



# EXTERIOR PHOTOS

